

**iRobot®**  
**Scoroba™**  
FLOOR WASHING ROBOT

---

**Owner's Manual**



[www.irobot.com](http://www.irobot.com)

**SAVE 15%**  
on accessories.  
See back for details.

## Welcome

Congratulations and welcome to the world of iRobot! You have joined the growing number of people who have discovered a smarter way to clean.



iRobot Scooba is an innovative and easy-to-use product that will change the way you clean hard floors. When you use Scooba in your home you will have the cleanest floors you've ever had without the mess and effort of other floor cleaning methods.

Please take a few moments to review this manual to get acquainted with Scooba. Should you have any further questions, visit our website at [www.irobot.com](http://www.irobot.com).

iRobot Corporation prides itself on listening to its customers, and we would like to hear from you. Please register your Scooba and tell us about your experience with your robot.

You can easily register your Scooba at **[www.irobot.com](http://www.irobot.com)**. By registering your robot, you've guaranteed to be notified of any product upgrades. **Plus you will receive 15% off your first order of cleaning solution and other accessories at [www.irobot.com](http://www.irobot.com).**

Thank you for joining the iRobot revolution. We look forward to bringing you more groundbreaking products that will change and improve your world.

Sincerely,

The iRobot Team

## Important Tips

**⚠ Use only the recommended amount of approved cleaning solutions. Other fluids may corrode electronic parts, cause excessive foaming, create poor traction, and will void the warranty. See page 14 for details.**

**⚠ Do NOT use bleach in Scooba. Bleach may damage the robot and will void the warranty.**

**⚠ Scooba contains electronic parts. Do NOT submerge Scooba or spray with water. Clean with a damp cloth only.**

**⚠ Store or operate Scooba in room temperature environments only, freezing may damage Scooba.**

**⚠ Scooba is not recommended for use on unfinished or unsealed wood, or pre-laminated flooring, which can easily be damaged by wet cleaning methods.**

**⚠ Always consult your floor manufacturer for approved cleaning methods.**

### For best performance

- Remove furniture, clutter, and lightweight rugs from area to be cleaned.
- Use the Virtual Wall to contain Scooba to one room.
- Always empty the Dirty tank after the cleaning cycle is complete.
- Rinse the Dirty tank before storage.
- Keep wheels and brush free from hair and debris by inspecting and cleaning the bottom of Scooba regularly.
- Remove and rinse the filter, brush, and vacuum port regularly.
- Always store Scooba plugged-in and recharging.

## Table of Contents

Scooba's Anatomy and Lights . . . . .	6 – 7
Scooba's Cleaning Pattern . . . . .	8
Battery Performance . . . . .	9
Battery Installation and Removal . . . . .	9 – 10
Charging Scooba . . . . .	10
Scooba's Tanks . . . . .	11 – 12
Scooba's Cleaning System . . . . .	13
Clorox® Scooba Cleaning Solution . . . . .	14
Scooba's Virtual Wall . . . . .	15
Scooba Maintenance . . . . .	16 – 17
Scooba Troubleshooting . . . . .	18 – 21
iRobot Customer Support . . . . .	22
Safety Instructions . . . . .	23

# Scooba's Anatomy

Scooba has two main parts: the robot base and a tank.

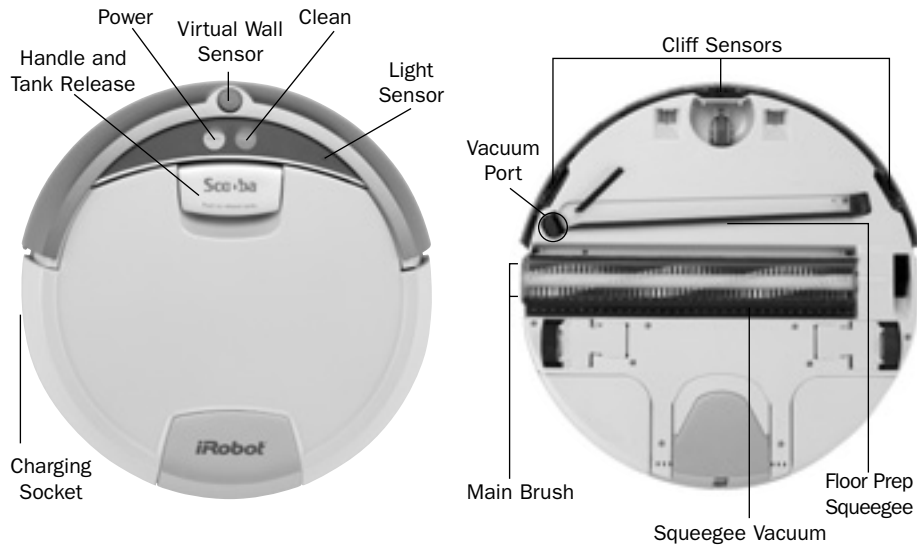

## Robot Base

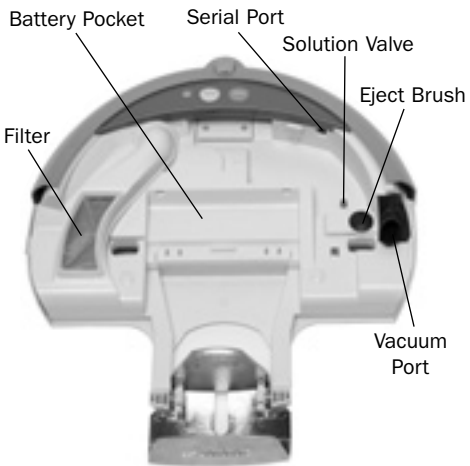

## Scooba's Tank

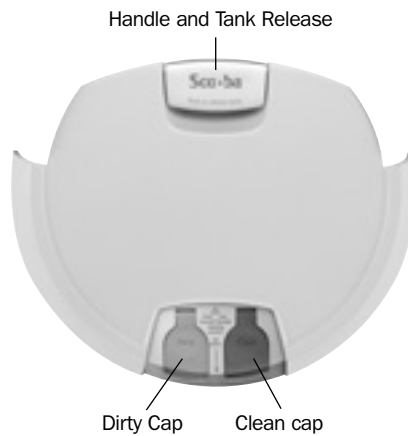

## Accessories



# Scooba's Lights

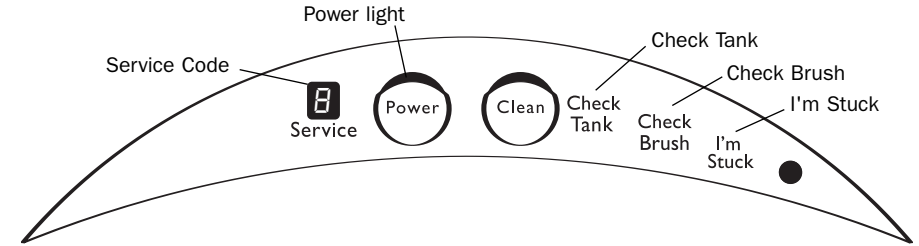

Power Button Light	Battery Status
Red	Battery empty
Green pulse	Charging
Solid green	Fully charged
Blinking red	Battery not installed

Clean Button Light	What it means
Green	Cleaning
Blue/Green pulse	Scooba is drying its cleaning head; the clean cycle is almost complete
Solid blue	The Clean tank is empty; the clean cycle is complete

## Warning Lights Quick Reference

See page 18 for detailed instructions.

Warning Lights	What to do
Check Brush	Remove and check brush (page 17)
I'm Stuck	Restart Scooba
Check Tank (Yellow)	Empty Dirty tank and close securely
Check Tank (Blue)	The Clean tank is empty (see page 20 for troubleshooting)

## Scooba's Cleaning Pattern

Scooba is a robot that cleans differently than the way most people clean their floors. Scooba uses iRobot's AWARE™ Robot Intelligence System to determine the best way to pass over and clean every section of the floor.

In most cases, Scooba will pass over the same area of the floor multiple times to ensure a thorough cleaning. Scooba can clean rooms up to 200 square feet with a full tank, while larger rooms may require an additional cleaning cycle.

**Tip: For smaller rooms, pre-mix 1 measuring cup of Clorox® Scooba cleaning solution with 1 quart of water. Partially filling the tank will shorten Scooba's cleaning time.**

While Scooba is cleaning it calculates the best path to clean your floor and determines the best times to use its various cleaning behaviors:

**Spiraling:** Enables Scooba to efficiently clean a concentrated dirty area.

**Wall following:** Enables Scooba to clean the room perimeter and navigate around furniture and obstacles.

**Room Crossing:** Enables Scooba to clean new areas while crisscrossing the room.

**Light Sensing:** Keeps Scooba from stopping in dark or hard-to-reach places.

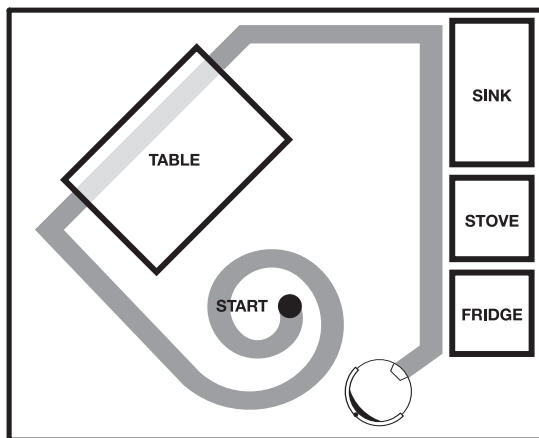

Scooba will alternate between spiraling, wall following, and room crossing during a cleaning cycle.

**TIP: For best performance and floor coverage, clear your floor of chairs, clutter, and light rugs. Use a Virtual Wall to contain Scooba to one room.**

## Battery Performance

Scooba is powered by a rechargeable battery. Scooba's battery will last for hundreds of cleaning cycles before needing replacement.



### Battery Storage

For best battery performance, iRobot recommends storing Scooba's battery in Scooba with the power supply plugged in.

### Battery Life

Fully charge Scooba's battery (up to 4 hours) before each cleaning cycle. When fully charged, Scooba's battery will always last longer than a full Clean cycle. If you would like to run Scooba more frequently, you can purchase additional batteries and chargers at [www.irobot.com](http://www.irobot.com). The battery should be replaced if Scooba cannot complete a cleaning cycle when fully charged.

### 16-Hour Refresh Charge

Under some circumstances, Scooba uses a special 16-hour charge cycle to extend Scooba's battery life. Scooba will use this charge cycle when the Scooba has been unplugged for an extended period of time or during the battery's first charge.

**TIP: For best performance, always store Scooba's battery on a plugged-in charger. Charge Scooba's battery overnight for the first charge.**

## Battery Installation and Removal

### Placing Battery in Scooba:

Rotate battery into its slot, making sure the yellow battery tabs fit inside the guide holes.

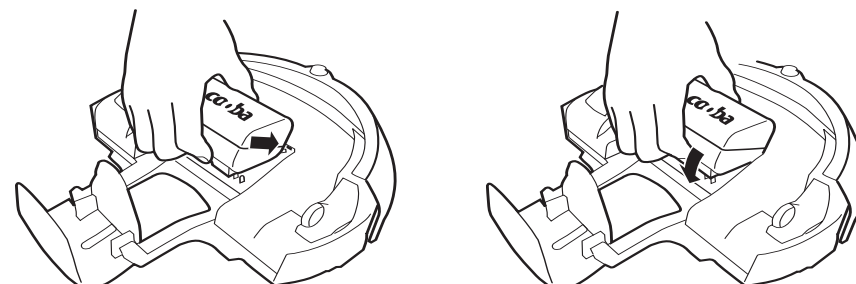

### Removing the Battery from Scooba:

Grip the battery, making sure to push the release tab, then rotate up.

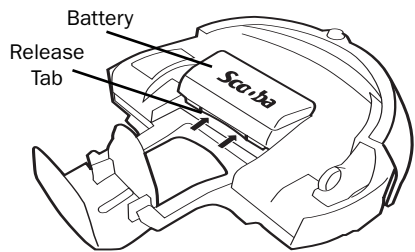

Push release tab

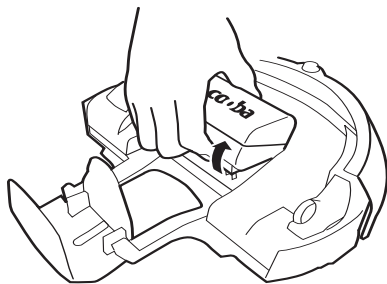

Rotate battery up

## Charging Scooba

Charge Scooba's battery by plugging the power supply into Scooba.

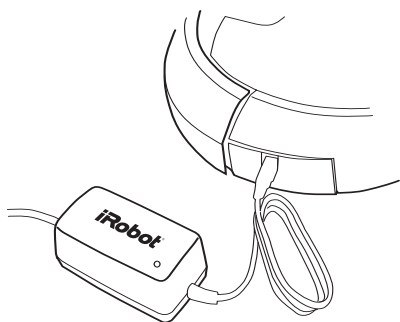

Scooba's Power Button Light	Battery Status
Red	Battery empty
Green pulse	Charging
Green fast pulse	16-hour refresh charge
Solid green	Fully charged
Blinking red	Battery not installed

**TIP:** Always make sure that the green power light of the power supply is ON while plugged into the wall.

## Scooba's Tank

Scooba's tank is completely removable from the robot base. Scooba has a unique two-chamber tank design that ensures fresh cleaning solution never mixes with the dirty water Scooba picks up as it cleans.

### Clean Tank

The Clean tank holds the Clorox® Scooba cleaning solution and water that Scooba uses to clean the floor. Before each use, the Clean tank is filled with water and 1 measuring cup (1-1/2 oz.) of Clorox® Scooba cleaning solution.

#### Fill the Clean tank before cleaning with Scooba.

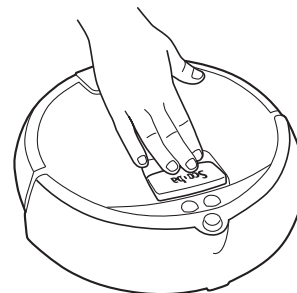

1 Press handle to remove tank.

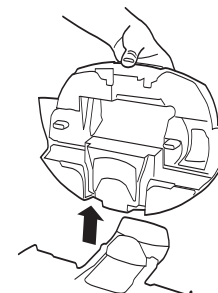

2 Remove tank from robot base.

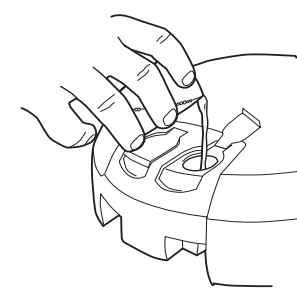

3 Using the included measuring cup, measure and pour Clorox® Scooba cleaning solution into the Clean tank.

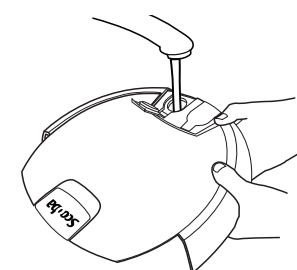

4 Slowly fill the remainder of the Clean tank with warm or cold tap water. Tilt the tank back and ensure it is completely filled to the top.

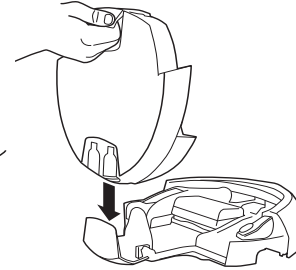

5 Push the Clean tank cap closed and place tank back in robot.

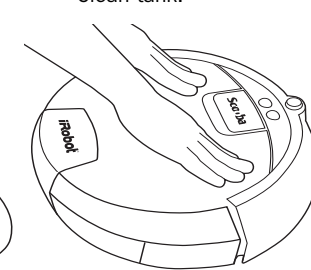

6 Push firmly on tank until you hear an audible click.

**CAUTION:** Fill with cold or luke-warm water only. Do not fill Scooba's tanks with hot water.

**CAUTION:** USE ONLY APPROVED CLEANING SOLUTIONS. Clorox® Scooba cleaning solution is specially formulated for Scooba. Other solutions may damage Scooba, causing corrosion of electronic parts, excessive foaming, and poor traction. Use of other solutions will void the warranty. See page 14 for details.

### Dirty Tank

Scooba puts down clean solution, scrubs the floor, and collects all of the dirty solution into the Dirty tank. Empty and rinse the Dirty tank after every cleaning cycle.

### Empty and rinse the tanks after every cleaning cycle.

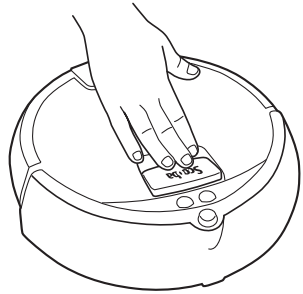

1 Press handle to release tank.

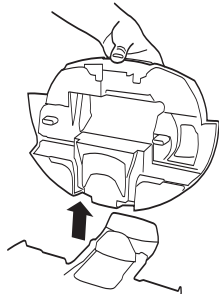

2 Remove tank from robot.

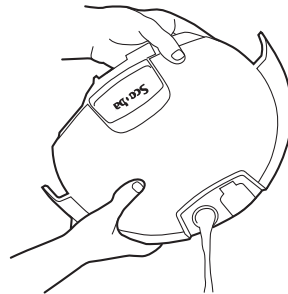

3 Empty Dirty and Clean tanks.

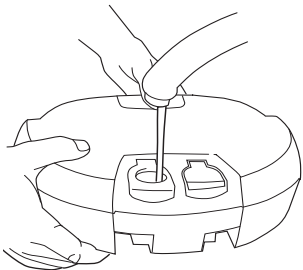

4 Rinse Dirty and Clean tanks with warm water.

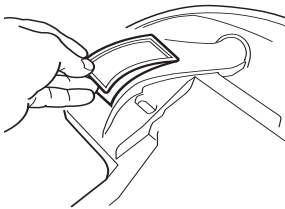

5 Remove and rinse Scooba's filter and vacuum port.

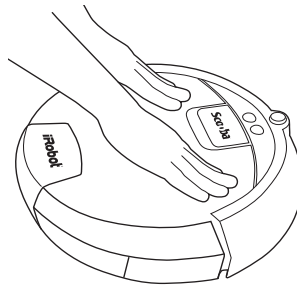

6 Place the tank back in Scooba. Push down firmly on the tank until you hear an audible click.

## Scooba's Cleaning System

Scooba uses four cleaning methods in every pass.

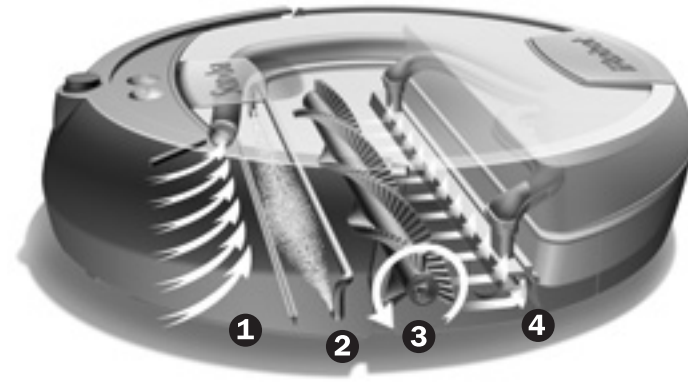

- 1) Preps** – Scooba picks up loose dirt and light debris from the floor. You do not need to sweep the floor before using Scooba unless you have large objects such as pebbles or large food particles on the floor.
- 2) Washes** – Scooba continuously lays down a small amount of fresh cleaning solution.
- 3) Scrubs** – Scooba gently scrubs to clean spills and grime.
- 4) Dries** – Scooba's squeegee vacuum picks up dirty water and debris, leaving your floor clean and dry.

Scooba will clean until it has used all of the solution in the Clean tank, approximately 45 minutes. At the end of a cleaning cycle, Scooba will enter a drying mode.

### Internal Drying Mode

At the end of the cleaning cycle, Scooba will enter a brief internal drying mode to remove any liquid remaining on its brushes and inside its cleaning mechanisms. During this time Scooba's Clean light will blink blue.

**TIP: If you wish to end a cleaning cycle early, iRobot recommends activating the internal drying mode first:**

- To start drying mode while the robot is cleaning, just press Clean.
- To start drying mode when Scooba is off, press Power & then press Clean twice.

## Clorox® Scooba Cleaning Solution



Clorox® Scooba cleaning solution is a specially formulated cleaning solution that is safe for use in Scooba. The solution is designed to be tough enough for cleaning, but safe around children and pets.

**⚠ CAUTION:** Use only approved cleaning solutions in Scooba. Other solutions may damage Scooba causing corrosion of electronic parts, excessive foaming, and poor traction. Use of other solutions may damage the robot and voids the warranty.

Clorox® Scooba cleaning solution has been specifically engineered to be safe and effective on hard floor surfaces, including tile, linoleum, vinyl, marble, slate, stone, and sealed hardwood.

The solution contains no bleach.

**⚠ CAUTION: DO NOT USE SCOOPA ON THESE SURFACES:**

- Carpet or rugs
- Unsealed hardwood or stone
- Laminate flooring (such as Pergo®)

Scooba is not recommended for use on unfinished or unsealed hard floor surfaces, carpet, rugs or waxed floors. These surfaces may be damaged by water (an unsealed floor does not have a coat of polyurethane to protect the sub-flooring from water damage). Additionally, Scooba is not safe for use with laminate flooring which may be damaged by wet cleaning methods.

**TIP:** When using Scooba on sealed hardwood floors, inspect the floor surface for worn finish, bare wood, or separated and unsealed joints. Do not use Scooba on your hardwood floor if any of these conditions exist. Follow the floor manufacturer's cleaning recommendations.

### Approved Cleaning Solutions

iRobot approves using only Clorox® Scooba cleaning solution or 2 oz. of white vinegar with Scooba. iRobot does not assume responsibility for floor damage caused by the use of vinegar on hard floor surfaces.

## Scooba Virtual Wall



The Scooba Virtual Wall creates an invisible barrier that Scooba will not cross. Virtual Walls can be set to block areas from three to eight feet wide.

**TIP:** Use the Virtual Wall to block doorways or to keep Scooba away from cords.

The Virtual Wall beam is keyhole shaped. A small halo prevents Scooba from bumping the Virtual Wall and a larger lobe-shaped section blocks off areas of your home where you don't want Scooba to go.

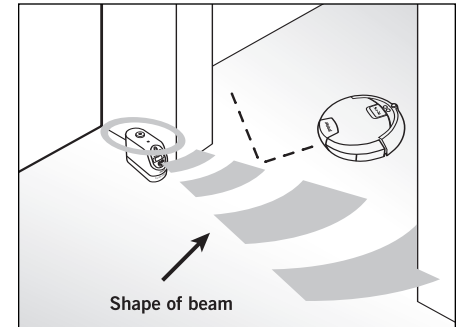

Virtual Walls require 2 "D" batteries. Virtual Walls will automatically shut themselves off at the end of a cleaning cycle.

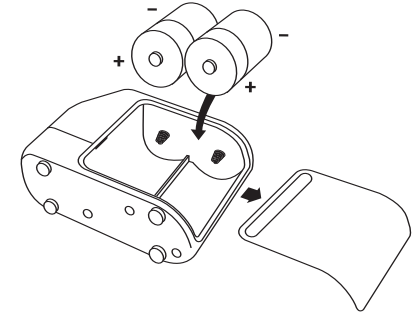

**TIP:** For best performance, place the Virtual Wall on the outside of the doorway you wish to block, and always set the Virtual Wall to the shortest setting possible.



# Scooba Maintenance

To keep Scooba running at peak performance, perform the following maintenance tasks after every cleaning cycle:

## Rinse Scooba's Dirty and Clean tanks

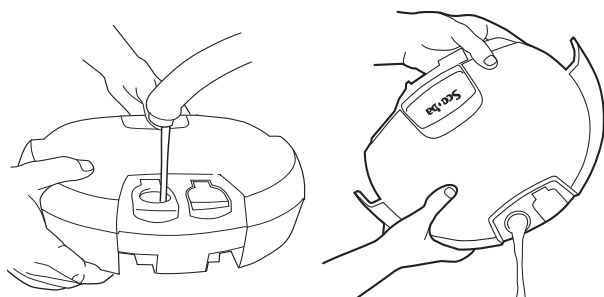

- 1 Partially fill the Dirty tank with water.
- 2 Empty and rinse both the Clean and Dirty tanks.

## Clean Scooba's filter

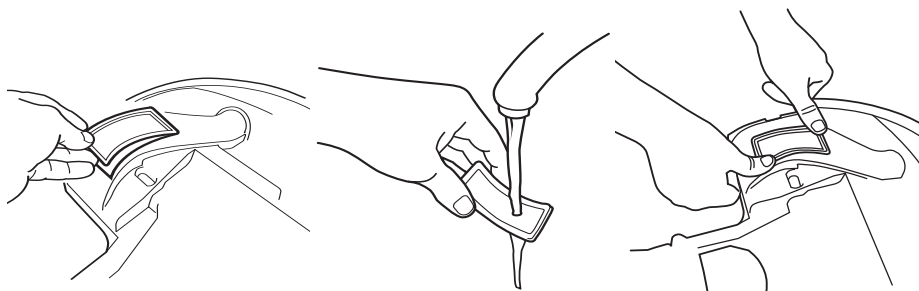

- 1 Remove filter.
- 2 Rinse under warm water.
- 3 Replace filter.

**⚠ CAUTION:** Scooba contains electronic components that can be damaged by spills of water or other liquids. Clean the bottom and top of Scooba with a damp cloth only. Do not pour or spray water onto Scooba, other than into the Clean or Dirty tanks.

## Clean Scooba's brush

Scooba's brush is located inside a cartridge called the "cleaning head." Access to the cleaning head is inside Scooba, so the tank needs to be open when removing and replacing the cleaning head.



- 1 Push the Eject Brush button to remove the cleaning head.
- 2 Open the cleaning head and remove the brush.
- 3 Rinse cleaning head and brush under warm water.

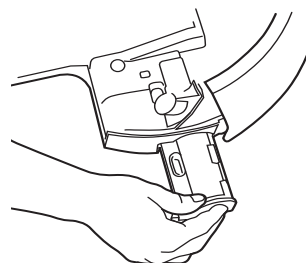

- 4 Replace Scooba's cleaning head.

## Rinse Scooba's vacuum port regularly

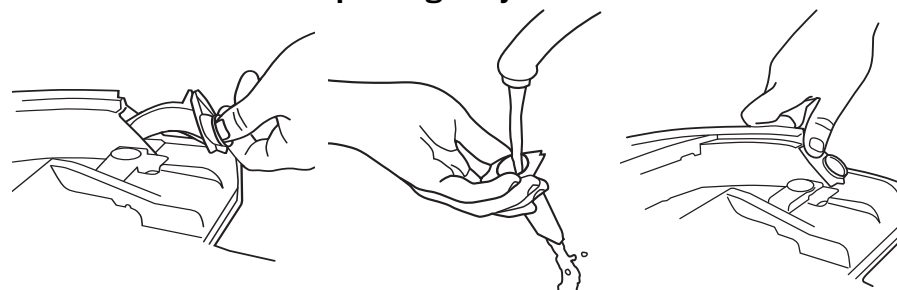

- 1 Remove vacuum port.
- 2 Rinse under warm water.
- 3 Replace vacuum port.

# Troubleshooting

## Warning Lights

Scooba has several warning lights that tell you if the robot needs assistance.

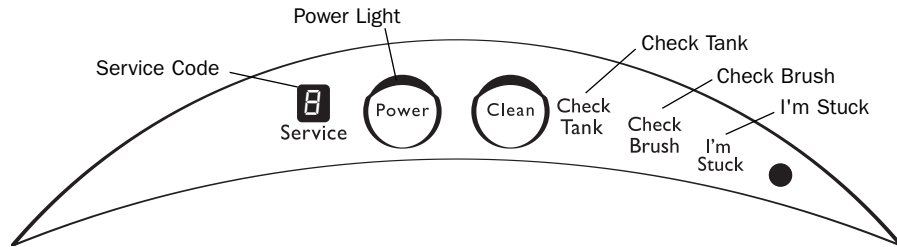

Warning Light	Possible Cause	What To Do
Check Brush	The brush is jammed.	Remove and clean Scooba's brush and cleaning head. With cleaning head and tanks removed, turn Scooba over, inspect and clean brush shaft.
	The cleaning head is improperly installed.	Remove and replace Scooba's cleaning head (page 17).
I'm Stuck	Scooba cannot move.	Confirm that Scooba's wheels are unobstructed and that they offer some resistance when turned by hand.
Check Tank <i>(Yellow)</i>	The tank is not in the robot.	Place the tank in the Robot and make sure the tank latch is securely closed.
	The filter is missing.	Remove, rinse and replace Scooba's filter. Ensure filter is installed properly (page 16).
	The Dirty tank is full.	Empty the Dirty tank.
Check Tank <i>(Blue)</i>	The Clean tank is empty and your cleaning cycle is complete.	Empty the Dirty tank and rinse (see page 20 for complete troubleshooting).
Power <i>(Red)</i>	Battery has lost its charge.	Recharge Scooba's battery (page 10).

## Service Codes

Scooba can self-diagnose problems. If Scooba's red service code comes on, refer to the following chart. If the problem persists, contact iRobot customer care at [www.irobot.com/support](http://www.irobot.com/support) for customer service assistance.



Error Code	What It Means	What To Do
1	Vacuum malfunction	Remove and rinse Scooba's filter and vacuum port (page 16).
2 or 3	Left wheel malfunction	Inspect the left wheel. Spin the wheel by hand, the wheel should offer some resistance. If it does not, or if it's stuck and you can't dislodge the obstruction, contact iRobot customer care.
4 or 5	Right wheel malfunction	Inspect the right wheel. Spin the wheel by hand, the wheel should offer some resistance. If it does not, or if it's stuck and you can't dislodge the obstruction, contact iRobot customer care.
7 or 8	Battery or Charger issue	Unplug the power supply and remove the battery. Re-insert the battery and ensure it is fully seated and clicks into place. Reconnect the power supply to the charging socket.
9	Charger issue	Contact iRobot customer care.
[	Scooba's cliff sensors are dirty or malfunctioning	Clean cliff sensors with a cotton swab (see page 6 for sensor location). The three cliff sensors are the black pieces located behind the bumper and are accessed by turning the Scooba over. Make sure the tanks are empty before turning Scooba over.
b	Bumper problem	Tap the bumper to ensure that it moves in and out. Visually inspect bumper edges for debris.
H	Battery is too hot	Make sure Scooba was not recently filled with hot water or charged in a hot place. Wait for Scooba and battery to cool down and try again.
d	One of Scooba's wheels is off the floor; you may have picked up the robot	Inspect all wheels. Push the wheels up and down. Put the robot back on the floor, press Clean.
E	Robot electronics malfunction	Remove any obstacles from brushes and wheels. If problem persists, contact iRobot customer care.
F	Front wheel malfunction	Ensure the front wheel can spin freely. Lightly push wheel up and down. If material is stuck in the wheel, the front caster wheel can be easily removed, cleaned and replaced. Put the robot back on the floor, press Clean.
P	Pump malfunction	Contact iRobot customer care.

### Blue Check Tank Troubleshooting

Normally, Scooba's blue "Check Tank" light illuminates when Scooba's Clean tank is empty. If the Check Tank is lit and the Clean tank is not empty, follow these steps to troubleshoot the issue.

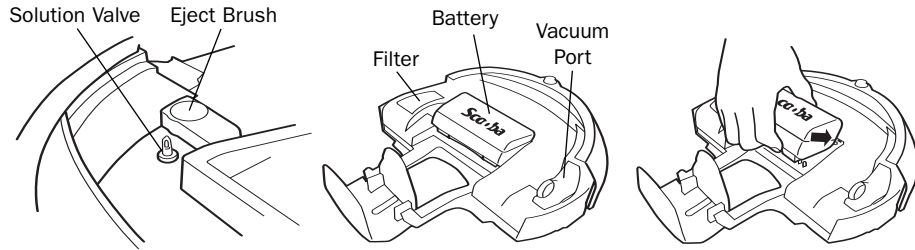
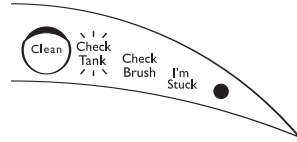

- 1 Inspect and clean Scooba's solution valve with a damp cloth.
- 2 Confirm that the battery, filter, and vacuum port are properly installed, and that the tank is completely closed.

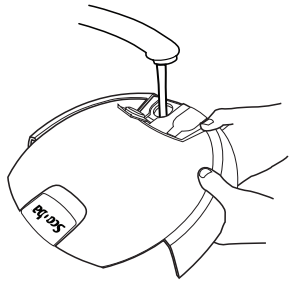

- 3 Fill Scooba's Clean tank with approximately 1 cup of cold water, shake vigorously, and empty it to remove any debris in the tank. Refill Scooba's Clean tank with water and Clorox® Scooba cleaning solution or vinegar. Use up to one full Scooba measuring cup of cleaning solution if the check tank light remains on.

**⚠ If the battery's yellow tabs are not inside the guide holes in the battery pocket, the tank and robot base may not be properly connected.**

**⚠ Use of only water or extremely small amounts of cleaning solution reduces Scooba's ability to recognize water in the Clean tank. Always use the recommended amount of cleaning solution and water.**

### General Troubleshooting

Problem	Likely Cause	What To Do
Scooba will not start cleaning	Power is off	Press power, then press Clean to start Scooba.
	Battery is not charged	Place battery into a plugged-in charger and charge it (page 10).
	Battery is not correctly seated	Remove battery and ensure that battery tabs are placed inside Scooba's guide holes before closing Scooba's tank.
	Blue "Check Tank" light illuminates	See page 20 for troubleshooting.
Excessive foam coming out of Scooba	There is too much cleaning solution concentrate in Clean tank.	Empty and rinse the Clean tank thoroughly. When re-filling, make sure to use only one measuring cup of Clorox® Scooba cleaning solution in a full tank (1 quart) of water. If you want to partially fill the tank for a smaller room, you need to pre-mix one measuring cup of cleaning solution in one quart of water before filling the tank.
Cleaning head sticks out of Scooba, will not engage	The cleaning head is not closed tightly over the brush.	With the tank open, slide the cleaning head out of Scooba. Squeeze the cleaning head completely closed over the brush before re-inserting it into its proper location. (page 17)

## Contact iRobot Customer Care

If you have questions or comments about Scooba, please contact iRobot before contacting a retailer.

Please visit our website at [www.irobot.com](http://www.irobot.com) for support tips, accessories, and frequently asked questions, we would like to hear from you.

### If you need further assistance:

- Visit the iRobot support website at [www.irobot.com/support](http://www.irobot.com/support)
- Call our customer care representatives at **877-855-8593**

iRobot Customer care hours:

Monday-Friday 9AM - 7PM Eastern Time

Saturday 9AM - 6PM Eastern Time

## Important Safety Instructions

**⚠ CAUTION: DO NOT EXPOSE ELECTRONICS OF SCOوبا, ITS BATTERY OR THE CHARGER. NO USER-SERVICEABLE PARTS INSIDE. REFER SERVICING TO QUALIFIED SERVICE PERSONNEL. CHARGE USING STANDARD U.S. (120V AC) OUTLET ONLY.**

**Always use care when operating Scooba. To reduce the risk of injury or damage, keep these safety precautions in mind when setting up, using and maintaining your Scooba:**

### GENERAL SAFETY INSTRUCTIONS

- Read all safety and operating instructions before operating Scooba.
- Retain the safety and operating instructions for future reference.
- Observe all warnings on Scooba, battery, charger and in owner's manual.
- Follow all operating and use instructions.
- Refer all non-routine servicing to a qualified service personnel.
- Your floor may be slippery while Scooba is cleaning and after the cycle is complete. Drying times may vary.

### SCOوبا USE RESTRICTIONS

- Scooba is for indoor, non-commercial use only.
- Use only approved cleaning solutions. Use of other cleaning solutions will void your warranty.
- Scooba is not a toy. Do not sit or stand on this device. Small children and pets should be supervised when Scooba is cleaning.
- Clean with a damp cloth only. Do not pour or spray water onto Scooba.
- Do not use this device to pick up anything that is burning or smoking.
- Do not use this device to pick up spills of bleach, paint, or other chemicals.
- Before using this device, pick up objects like clothing, loose papers, pull cords for blinds or curtains, power cords, and any fragile objects. If the device passes over a power cord and drags it, there is a chance an object could tumble off a table or shelf.
- If the room to be cleaned contains a balcony, a physical barrier should be used to prevent access to the balcony and ensure safe operation.
- Do not use this device to pick up flammable or combustible liquids such as gasoline.
- Always remove the battery before long-term storage or transportation.
- Operate at room temperature only. Freezing or excessive heat will damage Scooba.

### SCOوبا BATTERY AND CHARGING

- Operate your Scooba only from the type of power source indicated on the marking label. If you are not sure of the type of power supplied in your home, consult your local power company.
- Charge using a standard U.S. (120V AC) outlet only. Product may not be used with any type of power converter. Use of other power converters will immediately void the warranty.
- Use only the charger supplied by the manufacturer to charge this device.
- Do not use a charger with a damaged cord or plug.
- Charge indoors only.
- Never handle chargers with wet hands.
- Always disconnect Scooba from the charger before cleaning.



**iRobot®**  
**Scooba™**  
FLOOR WASHING ROBOT

**Register your  
iRobot® Scooba™  
today. SAVE 15%  
on all accessories.\***



**Clorox® Scooba  
Cleaning Solution**

Five 32 oz. bottles of  
Clorox Scooba Hard  
Floor Cleaner. Fills  
Scooba's tank 80  
times.

..... \$24<sup>99</sup>



**Scooba Virtual Wall®**

Keep Scooba cleaning  
where you want or  
away from obstacles.

..... \$29<sup>99</sup>



**Scooba Battery**

Get more continuous  
cleaning time from your  
Scooba with a second  
rechargeable battery.

..... \$59<sup>99</sup>



**Scooba  
Replenish Kit**

Replace Scooba's  
brush, wheels, vacuum  
port, and squeegees for  
optimal performance.

..... \$29<sup>99</sup>



**Scooba Wetsuit™**

15" diameter, washable  
storage mat for Scooba.

..... \$12<sup>99</sup>



**Scooba Battery  
Charger**

Rapidly charges  
Scooba's battery  
outside of the robot.

..... \$39<sup>99</sup>

Get iRobot accessories at:

**800.727.9077** or visit: **store.irobot.com**

*\*See registration card for details. Pricing and availability subject to change. Shipping and handling not included.*



© 2006 iRobot Corporation, 63 South Avenue, Burlington, MA 01803. All rights reserved. iRobot and Virtual Wall are registered trademarks of iRobot Corporation. Scooba is a trademark of iRobot Corporation. US Pat. Nos. 6,690,134 | 6,809,490 | 6,594,844. Other patents pending. Clorox is a registered trademark of The Clorox Company. All rights reserved. Pergo is a registered trademark of Pergo Incorporated. All rights reserved.