



# BRIAN THE BRAIN™

digital roommate



**BUDDY MANUAL**

### IMPORTANT SAFETY INSTRUCTIONS

When using your telephone equipment, basic safety precautions should always be followed to reduce the risk of fire, electric shock and injury to persons, including the following:

1. Do not use this product near water, for example, near a bath tub, wash bowl, kitchen sink or laundry tub, in a wet basement or near a swimming pool
2. Avoid using a telephone (other than a cordless type) during an electrical storm. There may be a remote risk of electric shock from lightning.
3. Do not use the telephone to report a gas leak in the vicinity of the leak.
4. Use only the power cord and batteries indicated in this manual. Do not dispose of batteries in a fire. They may explode. Check with local codes for possible special disposal instructions.

### SAVE THESE INSTRUCTIONS

### IMPORTANTES MESURES DE SÉCURITÉ

Certaines mesures de sécurité doivent être prises pendant l'utilisation de matériel téléphonique afin de réduire les risques d'incendie, de choc électrique et de blessures. En voici quelquesunes:

1. Ne pas utiliser l'appareil près de l'eau, pex., près d'une baignoire, d'un lavabo, d'un évier de cuisine, d'un bac à laver, dans un sous-sol humide ou près d'une piscine
2. Éviter d'utiliser le téléphone (sauf s'il s'agit d'un appareil sans fil) pendant un orage électrique. Ceci peut présenter un risque de choc électrique causé par la foudre.
3. Ne pas utiliser l'appareil téléphonique pour signaler une fuite de gaz s'il est situé près de la fuite.
4. Utiliser seulement le cordon d'alimentation et le type de piles indiqués dans ce manuel. Ne pas jeter les piles dans le feu: elles peuvent exploser. Se conformer aux règlements pertinents quant à l'élimination des piles.

### CONSERVER CES INSTRUCTIONS

**Warning:** Changes or modifications to this unit not expressly approved by the party responsible for compliance could void the user's authority to operate the equipment.

**NOTE:** This equipment has been tested and found to comply with the limits for a Class B digital device, pursuant to Part 15 of the FCC Rules. These limits are designed to provide reasonable protection against harmful interference in a residential installation. This equipment generates, uses, and can radiate radio frequency energy and, if not installed and used in accordance with the instructions, may cause harmful interference to radio communications. However, there is no guarantee that interference will not occur in a particular installation. If this equipment does cause harmful interference to radio or television reception, which can be determined by turning the equipment off and on, the user is encouraged to try to correct the interference by one or more of the following measures:

- Reorient or relocate the receiving antenna.
- Increase the separation between the equipment and receiver
- Connect the equipment into an outlet on a circuit different from that to which the receiver is connected.
- Consult the dealer or an experienced radio TV technician for help.

## CONSUMER INFORMATION

- a) This equipment complies with Part 68 of the FCC rules and the requirements adopted by the ACTA. On the **bottom** of this equipment is a label that contains, among other information, a product identifier in the format **US:MEGTE01B47050**. If requested, this number must be provided to the telephone company.
- b) An applicable certification jacks Universal Service Order Codes (USOC) for the equipment is provided (i.e., RJ11C) in the packaging with each piece of approved terminal equipment.
- c) A plug and jack used to connect this equipment to the premises wiring and telephone network must comply with the applicable FCC Part 68 rules and requirements adopted by the ACTA. A compliant telephone cord and modular plug is provided with this product. It is designed to be connected to a compatible modular jack that is also compliant. See installation instructions for details.
- d) The REN is used to determine the number of devices that may be connected to a telephone line. Excessive RENs on a telephone line may result in the devices not ringing in response to an incoming call. In most but not all areas, the sum of RENs should not exceed five (5.0). To be certain of the number of devices that may be connected to a line, as determined by the total RENs, contact the local telephone company. [For products approved after July 23, 2001, the REN for this product is part of the product identifier that has the format **US:MEGTE01B47050**. The digits represented by ## are the REN without a decimal point (e.g., 03 is a REN of 0.3). For earlier products, the REN is separately shown on the label.]
- e) If this equipment 47050 causes harm to the telephone network, the telephone company will notify you in advance that temporary discontinuance of service may be required. But if advance notice isn't practical, the telephone company will notify the customer as soon as possible. Also, you will be advised of your right to file a complaint with the FCC if you believe it is necessary.
- f) The telephone company may make changes in its facilities, equipment, operations or procedures that could affect the operation of the equipment. If this happens the telephone company will provide advance notice in order for you to make necessary modifications to maintain uninterrupted service.
- g) Should you experience trouble with this equipment, please contact Mega Brands America Inc. at Champlain NY, 12919, USA. (1-800-465-MEGA) for repair or warranty information. If the equipment is causing harm to the telephone network, the telephone company may request that you disconnect the equipment until the problem is resolved.
- h) Please follow instructions for repairing if any (e.g. battery replacement section); otherwise do not alternate or repair any parts of device except specified.
- i) Connection to party line service is subject to state tariffs. Contact the state public utility commission, public service commission or corporation commission for information.
- j) **NOTICE:** If your home has specially wired alarm equipment connected to the telephone line, ensure the installation of this 47050 does not disable your alarm equipment. If you have questions about what will disable alarm equipment, consult your telephone company or a qualified installer.

**NOTICE:** According to telephone company reports, AC electrical surges, typically resulting from lightning strikes, are very destructive to telephone equipment connected to AC power sources. To minimize damage from these types of surges, a surge arrester is recommended.

### Applicable for Coin or Pay Phone Only

To comply with state tariffs, the telephone company must be given notification prior to connection for customer-owned coin or credit card phone. In some states, the state public utility commission, public service commission or corporation commission must give prior approval of connection.

=====

This product meets the applicable Industry Canada technical specifications/Le Présent matériel est conforme aux spécifications techniques applicables d'Industrie Canada.

The Ringer Equivalence Number is an indication of the maximum number of terminals allowed to be connected to a telephone interface. The termination on an interface may consist of any combination of devices subject only to the requirement that the sum of the Ringer Equivalence Numbers of all the devices does not exceed five./ L'indice d'équivalence de la sonnerie (IES) sert à indiquer le nombre maximal de terminaux qui peuvent être raccordés à une interface téléphonique. La terminaison d'une interface peut consister en une combinaison quelconque de dispositifs, à la seule condition que la somme d'indices d'équivalence de la sonnerie de tous les dispositifs n'excède pas 5.

# HELLO

Thank you for purchasing Brian the Brain.  
Be sure to read and follow all instructions carefully before using this product.

## Caring for Brian the Brain

- Do not leave this product close to a source of heat or in direct sunlight.
- Do not operate this product outdoors.
- Operate this product in a dry area.
- Avoid sand and water. If moisture gets inside the electronic compartment, remove the batteries and allow it to dry thoroughly before using.
- Never place Brian the Brain in water.
- If Brian the Brain becomes dirty, carefully wipe with a soft damp cloth.
- If you are not going to play with Brian the Brain for an extended period of time, remove the batteries from the battery compartments.

## Battery Installation

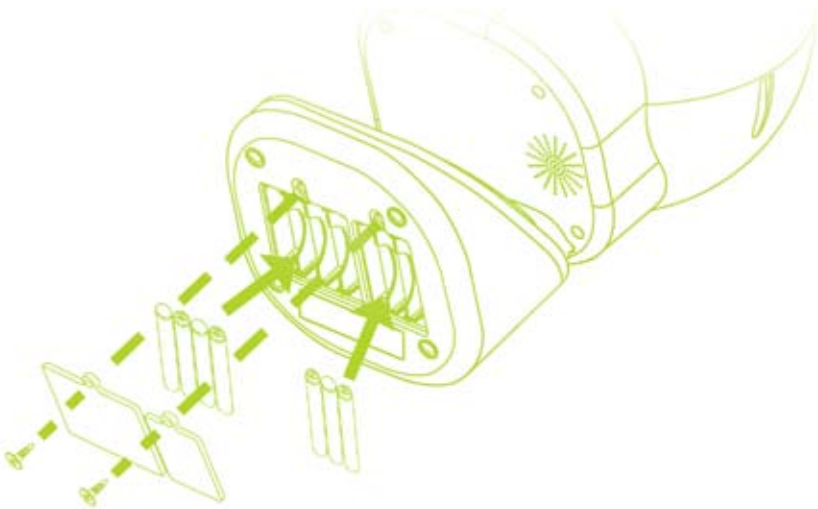

**The batteries that are in Brian the Brain are for demo purposes only.** Once you bring Brian home, you will need to replace these 4 AA batteries and also install additional 3 AAA batteries to have him fully functional. We recommend using fresh alkaline batteries for best performance. Do not use rechargeable batteries.

## Battery Installation

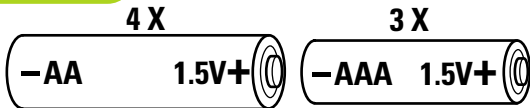

This toy uses 4 alkaline batteries (AA, LR6, 15A or equivalent).  
This toy uses 3 alkaline batteries (AAA, LR03, 24A or equivalent).

**Try me function works with 4 batteries that need to be changed prior to use by the consumer and add 3 other batteries at the same time.**

Non-rechargeable batteries included.

### BATTERY INSTALLATION

- Use a phillips (star-bit) screwdriver to unscrew the door of the battery compartment.
- Lift and remove the compartment door.
- Insert the batteries according to the correct polarity shown.
- Replace the door and the screws, do not over-tighten the screws.
- Replace the 4AA batteries when Brian no longer functions properly.

### CAUTION: TO AVOID BATTERY LEAKAGE:

1. See the diagram to know how to remove and insert batteries.
2. Non-rechargeable batteries must never be recharged.
3. Do not mix alkaline, standard (carbon zinc) batteries. Do not mix used and new batteries together.
4. Only batteries of the recommended type or of a similar type should be used.
5. Batteries must be inserted according to the correct polarity (see diagram).
6. Remove batteries from product when storing for an extended period of time or if batteries are exhausted.
7. The supply terminals must not be short-circuited.

**CAUTION:** Batteries are to be changed by an adult. Do not leave batteries within reach of children.  
Do not dispose of batteries in fire. Batteries may explode or leak.

## Getting to know Brian the Brain

1. Key Pad Controller
2. Base Unit and Brain
3. Room Guard Sensor
4. MP3 Player Jack
5. Phone Line Jack

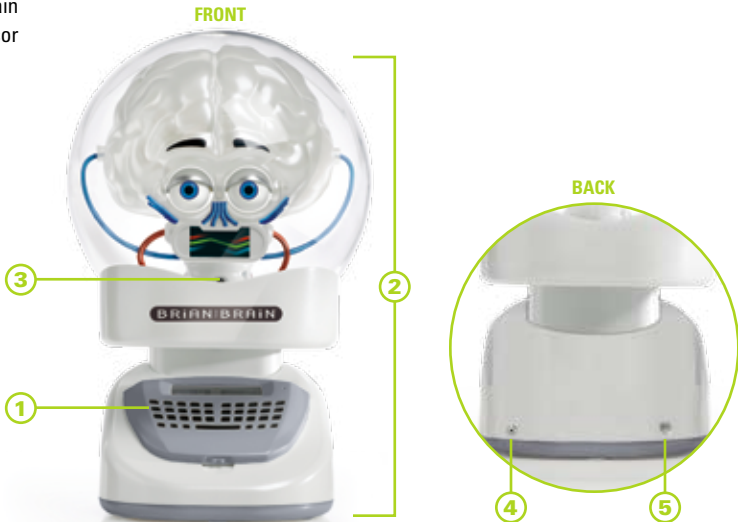

Be careful when removing the keypad from the base. Do not pull too hard or the cord may be damaged.

[www.mybrianthebrain.com](http://www.mybrianthebrain.com)

# Key Pad Controller

## Reset Button

Press for initial start-up, or if Brian freezes or acts erratically. This operation must be done by an adult: **Use the end of a paper clip to depress the recessed button located inside the hole.**

**NOTE:** Press the reset button will reset the password, date and time. Hold "R" button and Reset will clear all information set before.

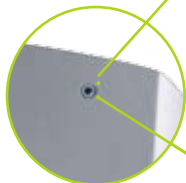

BACK

## Microphone

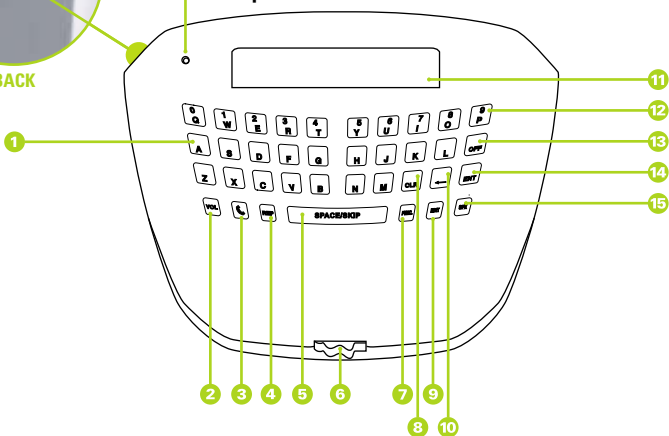

1) <b>Alphabet Buttons</b>	Used to type in letters.
2) <b>Volume Control Button</b>	Press to set 1 of 3 volume settings - low, medium, high. The volume control only affects Brian's voice and not your music player or phone volume.
3) <b>Phone Icon Button</b>	Press to answer when Brian rings, press again to end the call.
4) <b>Repeat Key</b>	Press to have Brian repeat his last statement.
5) <b>Space/Skip Bar</b>	Use to add a space between letters or numbers, and to "fast-forward" Brian through his conversation.
6) <b>Scroll Wheel</b>	Use the wheel to scroll through options shown on LCD screen.
7) <b>FUNC Button</b>	Press to activate Brian's function mode.
8) <b>CLR Button</b>	Press to delete everything that you have typed in.
9) <b>EDIT Button</b>	Press to activate edit mode.
10) <b>Backspace Button</b>	Press to back up one letter at a time, clearing that letter.
11) <b>LCD Screen</b>	Shows information, instructions and confirms your entries and answers.
12) <b>Number Buttons</b>	Used to type numbers. If Brian asks you to input numbers the keypad will automatically switch to numbers.
13) <b>OFF Button</b>	Turns Brian off.
14) <b>ENT Button</b>	Press to confirm you have finished typing in your entry.
15) <b>SFX Button</b>	Press to hear Brian's sound effects.

## Getting Started

### Turning On Brian for the First Time:

This operation must be done by an adult:

**Hold down the “Q” key and push the RESET button at the same time. First, release the RESET button, and then release the “Q” button after 2 seconds.**

### Enter Your Name:

Brian’s your new best buddy - he will ask you for your name. Type it in using the keypad controller. If he is familiar with your name, he will call you by your name. If not, he’ll call you pal, buddy or dude.

### Password Set Up:

Brian is a password protected to make sure that it is really you that is interacting with him. He’ll guide you through setting up your secret password - think of a word that is easy for you to remember. To make it easy for you to remember and for Brian to understand, use a word with just one syllable like “SMART” or “BLUE”. Make sure you are by yourself in a quiet room so no one else can hear you tell Brian your password!

When Brian asks you to say your password, hold the keypad about 12”inches [30cm] from you and speak clearly but in a normal voice. Brian will ask you to repeat your password.

Brian will also ask you to type in your password. He will then ask you to type it in again for confirmation. If you want, you can type in a password that’s different from the one you spoke to Brian - he’ll remember both. Your typed-in password must be shorter than 16 letters.

### Password Reset:

If you have forgotten your password and want to reset it, enter the following code when Brian is asking who you are: **Hold down the “Q”, “SPACE/SKIP” and “P” buttons at the same time.**

### Time and Date Set Up:

Brian will tell you how to set up the correct time and date.

## Playing with Brian

ONCE YOU'VE ENTERED YOUR NAME, SET UP YOUR PASSWORD AND PUT IN THE CORRECT TIME AND DATE - YOU'RE ALL SET!

Here's some hints to make sure you have the most fun with Brian the Brain: Like you, Brian doesn't like to be interrupted when he's talking. Make sure he's finished speaking before telling him what you'd like to do.

Brian's got super-sensitive hearing! Play in quiet room so he can hear your voice, and hold the keypad about 12" inches [30cm] away from you. Speak clearly and in a regular voice. If Brian can't hear you, he'll let you know and ask you to type in your response.

**REMEMBER - BRIAN THE BRAIN IS AT YOUR COMMAND!  
JUST SAY "HEY BRIAN" AT ANY TIME AND HE'LL STOP WHAT HE'S DOING  
AND ASK YOU WHAT YOU WANT TO DO!**

Brian will ask you questions about yourself or ask you to do things with him. Brian is very smart - he remembers things that you have told him about yourself and will talk to you about them.



## Voice Recognition

Brian understands some words that you say. When he asks you to say YES or NO, he will understand you. If you would like Brian to perform one of his functions, you need to get his attention first. Just say "HEY BRIAN". He'll hear you and ask you what you would like to do.

Here are the voice commands Brian the Brain will recognize. When he asks you what you would like to do next, just say the word listed below under VOICE COMMAND. Brian's function is explained after the command word.

<b>Hey Brian</b>	Brian will ask what you want to do.
<b>Yes. No</b>	Basic answers to Brian's questions.
<b>Repeat</b>	Brian will repeat what he just said.
<b>Turn Off</b>	Brian will shut down.
<b>Joke</b>	Brian will tell you a joke, and ask if you want to hear more.
<b>What Time is it</b>	Brian will tell you the time and date. or you can follow his instructions to set or turn off the alarm.
<b>Info</b>	Brian will give you information from the Britannica Concise Encyclopedia on a topic that interests you. Follow his instructions to enter the topic.
<b>Look Up Word</b>	Brian will search his on-board dictionary to find the definition of the word you want to know. Follow his instructions to enter the word.
<b>Trivia Quiz</b>	Brian will access his trivia bank and ask you a question. When you're ready to hear the answer, press the ENT button and he'll tell you the answer.
<b>Phone Call</b>	Brian will go into phone mode, so you can make a call by entering the number into the keypad or by accessing your contact information. You can also add, delete or change your contact information.

<b>Play a Game</b>	Brian will go into game mode. Follow his instructions to play one of seven different games.
<b>Chat</b>	Brian will chat with you.
<b>History</b>	Brian will give you info on "this day in history" - important events that happened on the days of the year.
<b>Guard</b>	Brian will go on Room Guard duty. Once activated, you have 30 seconds to leave the room. If someone enters the room, Brian will raise the alarm.
<b>Calendar</b>	Brian will go to your personal organizer so you can enter special activities and events. He'll remind you of these events the day before and the day they are to happen.
<b>Music</b>	Brian will go into music mode. Hook up your MP3 player and turn it on to hear your tunes and see a cool light show. Press the FUNC button to stop play.

**SPEACH TIP:** Speak at your normal voice level. If you Whisper or Shout, Brian will not understand

**REMEMBER - BRIAN THE BRAIN IS AT YOUR COMMAND!  
JUST SAY "HEY BRIAN" AT ANY TIME AND HE'LL STOP WHAT HE'S DOING  
AND ASK YOU WHAT YOU WANT TO DO!**

IF YOU DO NOT WANT TO TALK TO BRIAN IN ORDER TO ACCESS ANY OF HIS FUNCTIONS,  
OR IF BRIAN IS HAVING A PROBLEM UNDERSTANDING YOU, YOU CAN PRESS THE "FUNC" KEY  
AND SCROLL THROUGH THE MENU OF FUNCTIONS.

YOU CAN ALSO TYPE IN "Y" OR "N" WHEN BRIAN ASKS YOU FOR A YES OR NO ANSWER

***PLEASE NOTE:***

**911 AND OTHER EMERGENCY SERVICE NUMBERS CANNOT BE ACCESSED THROUGH BRIAN THE BRAIN.  
YOU MUST USE A TRADITIONAL PHONE OR MOBILE PHONE TO ACCESS 911 OR  
OTHER EMERGENCY SERVICE NUMBERS.**

## Friends

Up to four friends can tell Brian about themselves. Once Brian knows your friends, then he'll be able to interact with them too. To allow your friends to talk to Brian, press the "FUNC" button and select: Add Friends. Brian will ask them for their name and a password. Passwords for friends are only typed in.

## Editing

Brian knows that you can change your mind sometimes. If you would like to change an answer you gave to Brian, press the EDIT key. Scroll through the menu to find the right category, select the category, then select the specific topic and sub-topic you want to edit.

## Personal Information

---

### About Me

Name  
Gender  
Birthday  
Location

Where you live  
Weather

Winter  
Summer  
Autumn

### Family

Brothers  
Brother's Birthday  
Sisters  
Sister's Birthday  
Mother's Birthday  
Father's Birthday

### Friends

Best Friend  
Best Friend's Birthday  
Pet

Eats

Type of Food  
Food  
Snack  
Dessert  
Drink

Things to Do

Activity  
Sport to Play  
Musical Instrument  
Holiday  
School Spirit  
Chores

Name of School  
Favorite Subject  
Least Favorite Subject

Easiest Chore  
Least Favorite Chore

Entertainment

Sport to Watch  
Favorite Athlete  
Type of Music  
Type of Movie

## Password

---

## Phone Numbers

---

## Time and Date

---

Reset Clock

Reset Calendar

Wake-Up Alarm

Schedule

Meal Time

Lunch Time  
Dinner Time

Bed Time

# A Gift FOR YOU



ENCYCLOPÆDIA

Britannica Online  
*Student Edition*

**This certificate entitles you to use  
Encyclopædia Britannica Online Student Edition **FREE** for three months!**

Your subscription will begin on the day you activate your account by following these simple instructions:

1. Access the online registration form provided at: [www.britannica.com/brianthebrain](http://www.britannica.com/brianthebrain)
2. Enter the Promotion Code that appears below.
3. Follow the steps to create your password and account profile.

*Please note: You must have Internet access in order to activate your subscription. Certificates cannot be applied to current, active Encyclopædia Britannica Online accounts. Certificates are not redeemable for cash. If you have questions, please visit <http://account.britannica.com/faq.html>*

© 2007 Encyclopædia Britannica, Inc.

Promotion Code:

**brainpromo**

47050 / Brian the Brain / 8+ years

Please read these instructions carefully before first use and keep them for future reference.

For Europe: Please return the electric module to the store for recycling.



© 2007, MEGA Brands Inc.



Keep this information.

MEGA Brands Europe N V  
Postbus 95  
B-9140 Temse, België

IF YOU HAVE A PROBLEM,  
PLEASE DO NOT TAKE THIS TOY  
BACK TO THE STORE. CONTACT US

For warranty information,  
please consult [www.mybrianthebrain.com](http://www.mybrianthebrain.com)

1-800-465-MEGA • [WWW.MEGABLOKS.COM](http://WWW.MEGABLOKS.COM)

U.S. & Canada only / Solamente en EEUU y Canadá /

É.U. et Canada seulement / Nur für U.S & Kanada /

Uitsluitend in de V.S. en Canada / USA e Canada solamente /

Somente EE.UU. e Canadá

[www.mybrianthebrain.com](http://www.mybrianthebrain.com)

- 10 For Europe: Please return the electric module to the store for recycling.
- 10 En Europa: Por favor, devuelva el módulo eléctrico a la tienda para que lo reciclen.
- 10 Europe: Veuillez rapporter le module électronique au magasin pour recyclage.
- 10 In Europa: Das elektrische Modul bitte zur Wiederverwertung ins Geschäft zurückbringen.
- 10 In Europa: A.u.b. de elektrische module naar de winkel terugsturen voor hergebruik.
- 10 I Europa: Værsgo at sende den elektroniske modul tilbage til butikken for genanvendelse.
- 10 Στην Ελλάδα: Παρακαλώ να επιστρέψετε στο κατάστημα το ηλεκτρικό εξάρτημα για ανακύκλωση.
- 10 Euroopa: Palauta sähkökomponentti liikkeeseen kierrätettäväksi.
- 10 Europa: Vogliate riportare il modulo elettronico al negozio per riciclaggio.
- 10 I Europa: Vennligst send den elektriske modulen tilbage til butikken for gjenvinning.
- 10 Na Europa: É favor devolver o módulo eléctrico à loja para reciclagem.
- 10 I Europa: Var god lämna tillbaka elmodulen till affären för återanvändning.
- 10 欧州用：電子モジュールはリサイクルのために専門店に運ぶください。
- 10 台湾台語版：請將電氣零件送回專店以資回收利用



Printed in China  
AD470502





